



- Faculty, staff and students surveyed in February and early March
- **26,700+** responses with over a 47% response rate
- **80%** have already received or plan to receive vaccine with **10% undecided**

Survey completed
March 6



% not planning on receiving vaccine by university connection

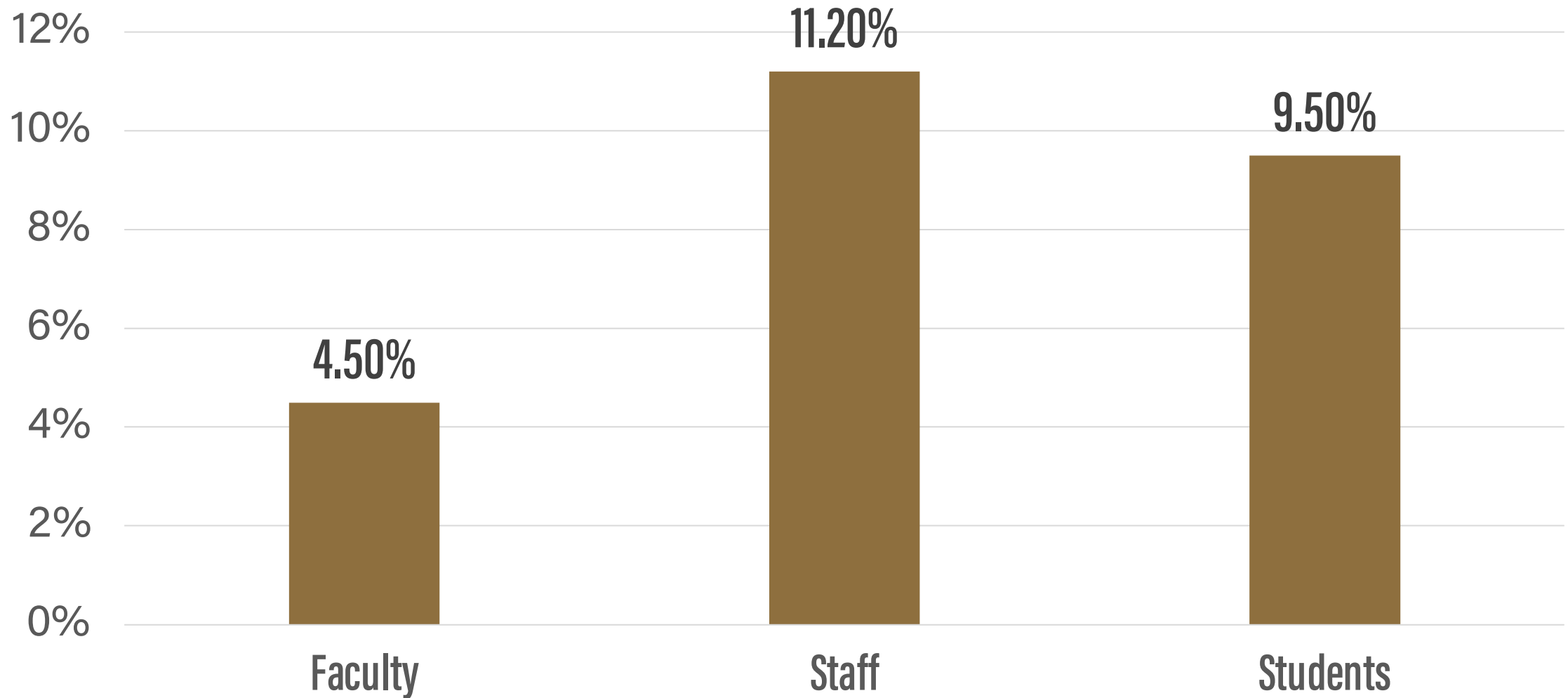

% not planning on receiving vaccine by race

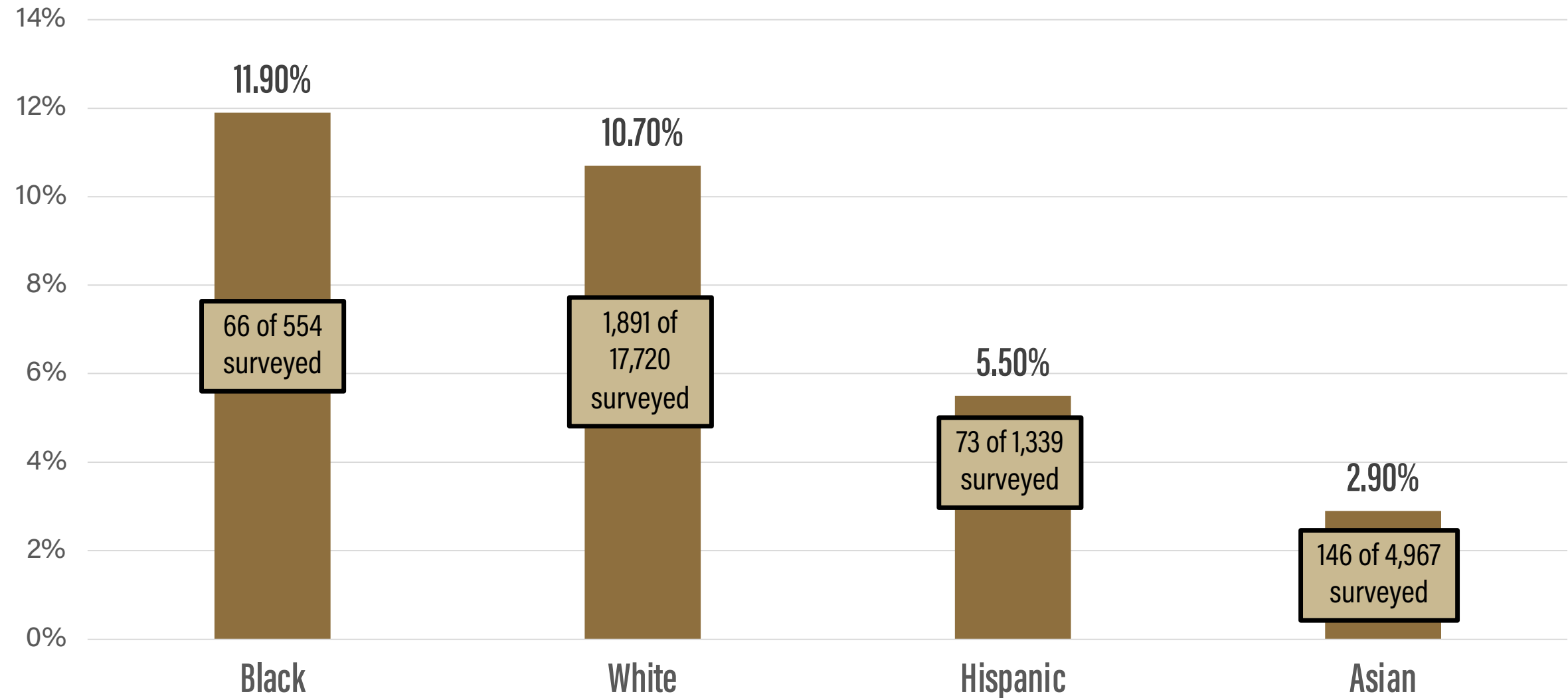

Reason not planning on vaccine

n=2,515

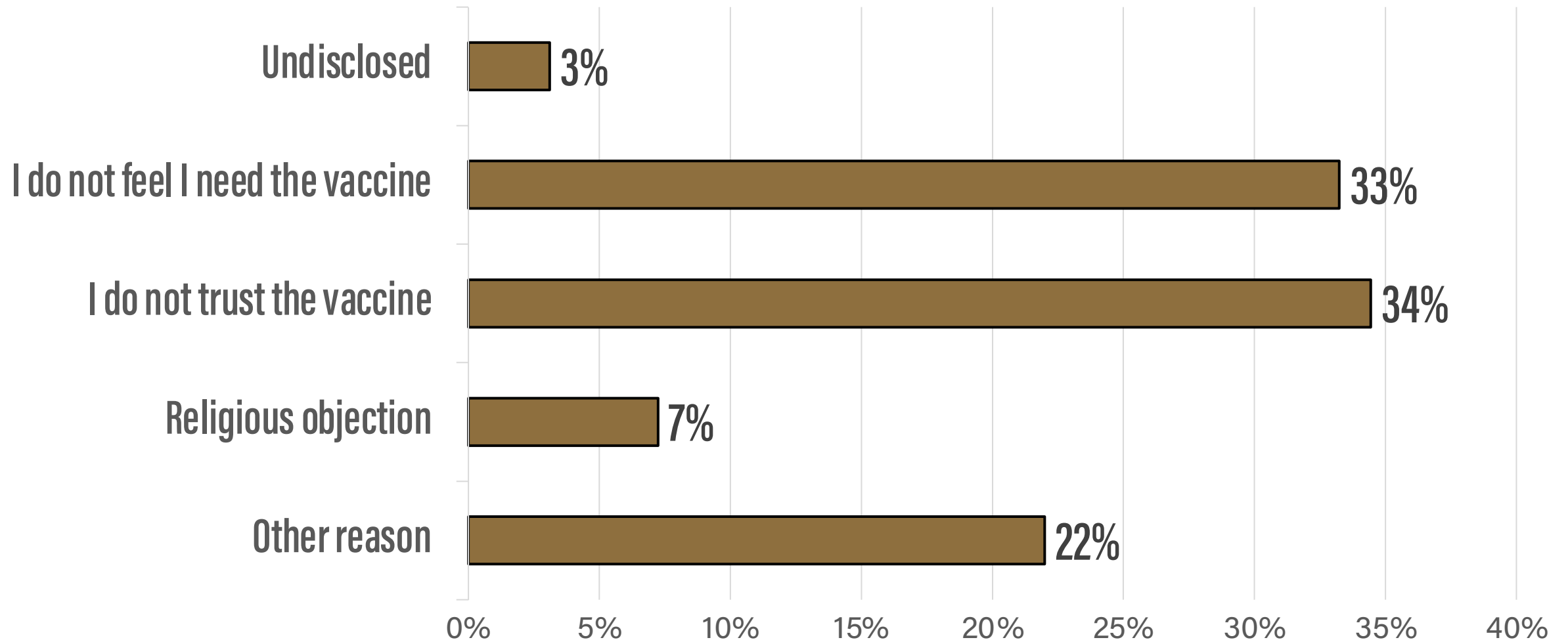

- How should Purdue encourage vaccine use?
- What incentives would be most effective and appropriate?

- Faculty & staff network logins down 57% vs. Pre-COVID
- **Schleman:** 287 assignable desks with an estimated 20-30 occupied in October
- **Krannert:** 800 assignable desks with 50-60 occupied in February
- **Young Hall:** 750 assignable desks with 50 occupied in Feb/March

Parking Garages: 41% of capacity

Commuter (C parking Lots): 27% of capacity

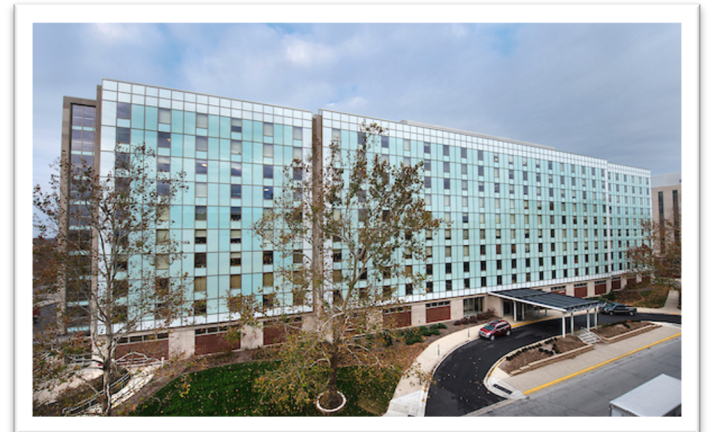

- As we return from the pandemic, what reconfigurations would better utilize our physical space to support the university's mission?
- How can the performance review period be utilized to assess individual interest in hybrid or remote work as well as unit effectiveness?