

Homework H22.A

Given: Consider the truss shown below with the loading on joints D, H and K.

Find: Use the method of sections to determine the load carried by members CE, EH and HR. Identify each member as either being in tension, in compression or carrying zero load.

For this problem, use the following parameters: $F = 50 \text{ kN}$ and $P = 80 \text{ kN}$.

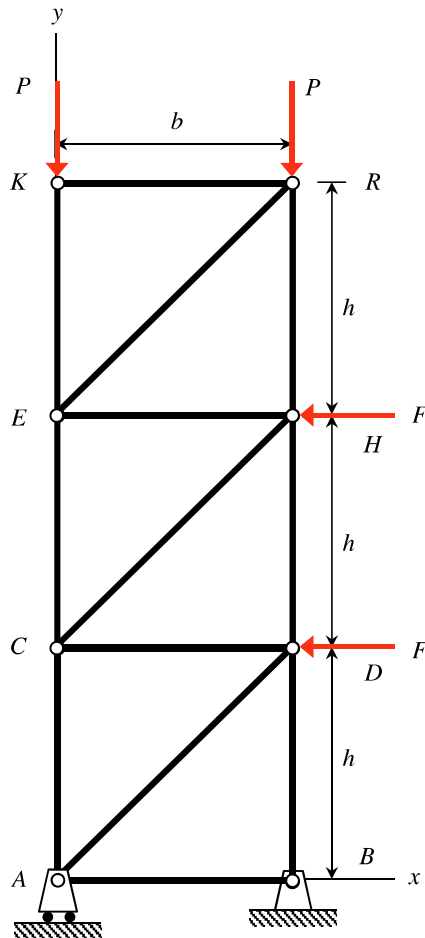

Homework H22.B

Given: Consider the truss shown below with the loading on joints D, H and K.

Find: For this problem:

- Determine the external reactions acting on the truss at supports A and E.
- Use the method of sections to determine the load carried by members BC, CH and HR. Identify each member as either being in tension, in compression or carrying zero load.

For this problem, use the following parameters: $h = 6$ ft, $b = 8$ ft, $F = 12$ ksi and $P = 36$ ksi.

